

ALL SECTIONS SHOWN ARE OF A TYPICAL INSTALLATION.
REQUIREMENTS MAY CHANGE DEPENDING ON INDIVIDUAL SITE CONDITIONS.

	BIFOLD DOORS	AUTHOR Luke Wynder		
		DATE 02/05/2012		
	VERTICAL CROSS SECTION			
A3	OPEN IN - SILL OPTION = 0			01

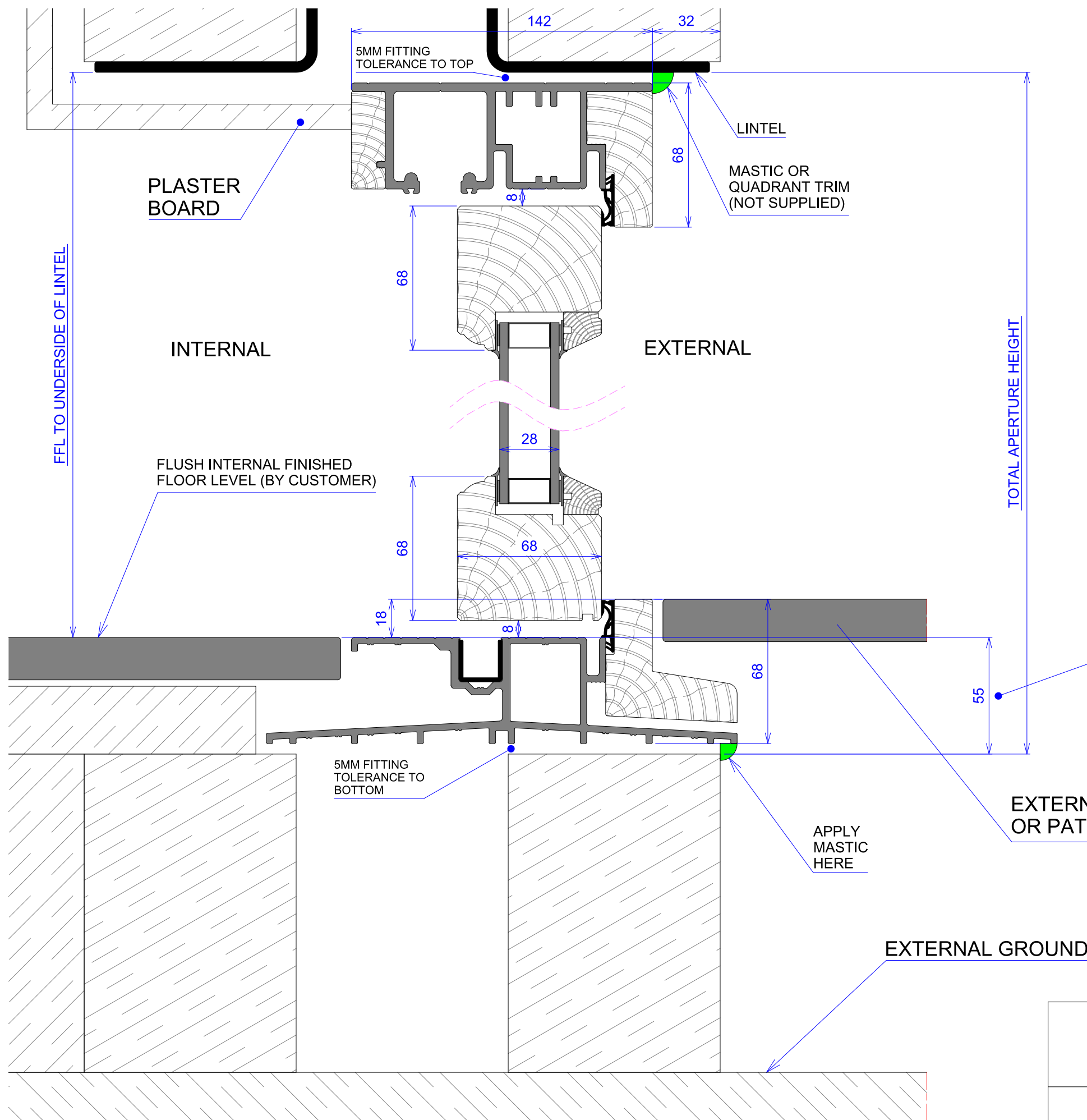

TO ACHIEVE A FLUSH FLOOR LEVEL INTERNALLY, THE CUSTOMER CAN EITHER BUILD THE FLOOR LEVEL UP OR REMOVE BOTTOM BRICKS AND INCREASE THE OVERALL FRAME HEIGHT TO SUIT

EITHER SPECIFY TOTAL APERTURE HEIGHT OR FROM UNDERSIDE OF LINTEL TO INTENDED INTERNAL FINISHED FLOOR LEVEL

ALLOW AT LEAST 55MM BELOW INTERNAL FFL FOR FRAME BOTTOM RAIL

EXTERNAL DECKING OR PATIO (BY CUSTOMER)

EXTERNAL GROUND

ALL SECTIONS SHOWN ARE OF A TYPICAL INSTALLATION.
REQUIREMENTS MAY CHANGE DEPENDING ON INDIVIDUAL SITE CONDITIONS.

	BIFOLD DOORS	AUTHOR Luke Wynder		
		DATE 02/05/2012		
A3	VERTICAL CROSS SECTION			
	OPEN IN - SILL OPTION = 2			
				01

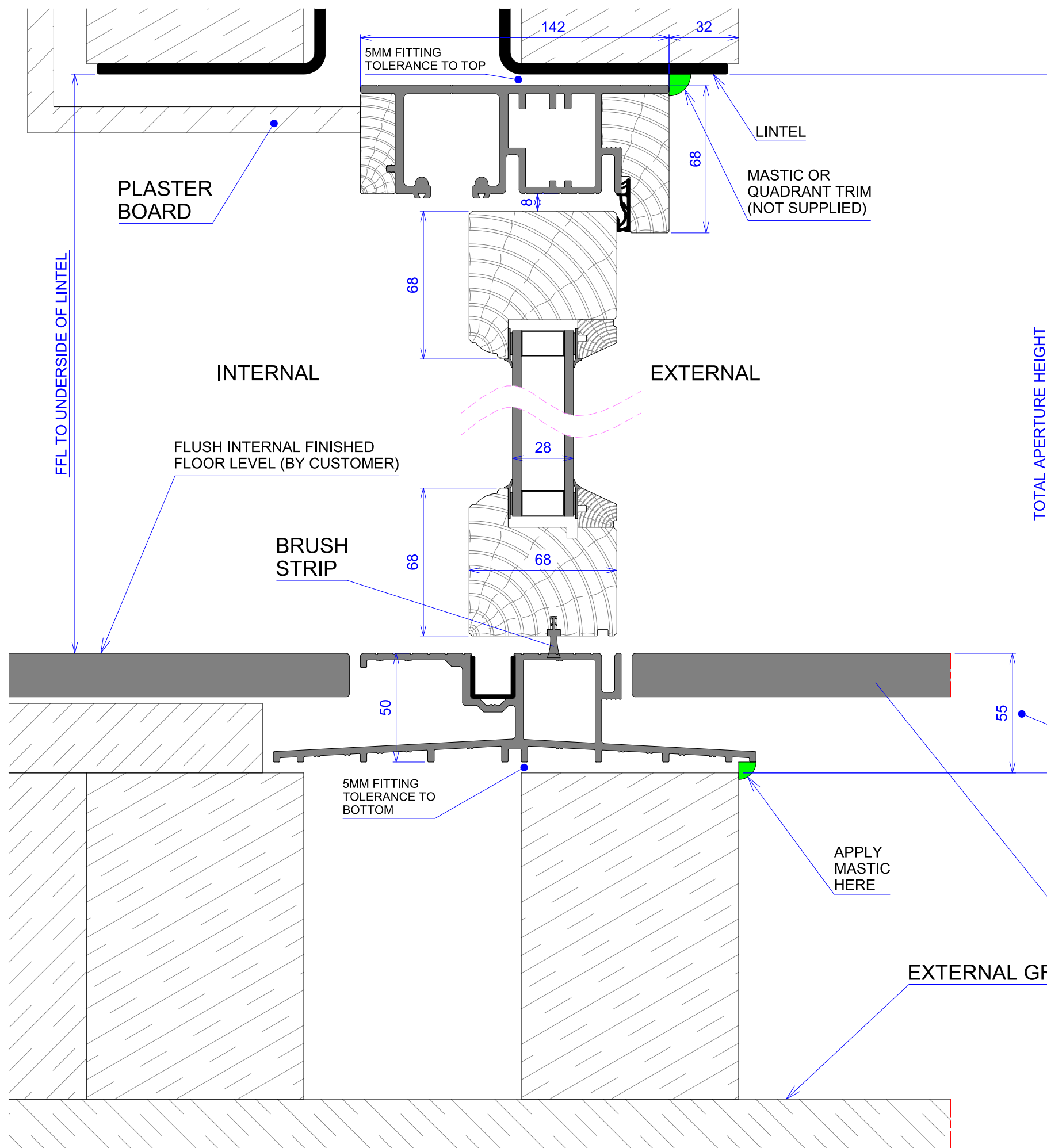

TO ACHIEVE A FLUSH FLOOR LEVEL INTERNALLY, THE CUSTOMER CAN EITHER BUILD THE FLOOR LEVEL UP OR REMOVE BOTTOM BRICKS AND INCREASE THE OVERALL FRAME HEIGHT TO SUIT

EITHER SPECIFY TOTAL APERTURE HEIGHT OR FROM UNDERSIDE OF LINTEL TO INTENDED INTERNAL FINISHED FLOOR LEVEL

THIS SILL OPTION IS MAINLY SUITABLE FOR SHELTERED LOCATIONS ONLY

THE BRUSH STIPS IN THE BOTTOM OF THE DOORS MAY NOT FULLY MEET AT EDGES OF DOORS

THE DOORS MAY ALSO HAVE A FEW MM OF PLAY AT THE BOTTOM DUE TO THE ABSENCE OF THE LOWER INTERNAL SEAL STOP UPSTAND FOR THE DOORS TO CLOSE AGAINST

ALLOW AT LEAST 55MM BELOW INTERNAL FFL FOR FRAME BOTTOM RAIL

ALL SECTIONS SHOWN ARE OF A TYPICAL INSTALLATION. REQUIREMENTS MAY CHANGE DEPENDING ON INDIVIDUAL SITE CONDITIONS.

	BIFOLD DOORS	AUTHOR Luke Wynder		
		DATE 02/05/2012		
	VERTICAL CROSS SECTION			
A3	OPEN IN - SILL OPTION = 3			01

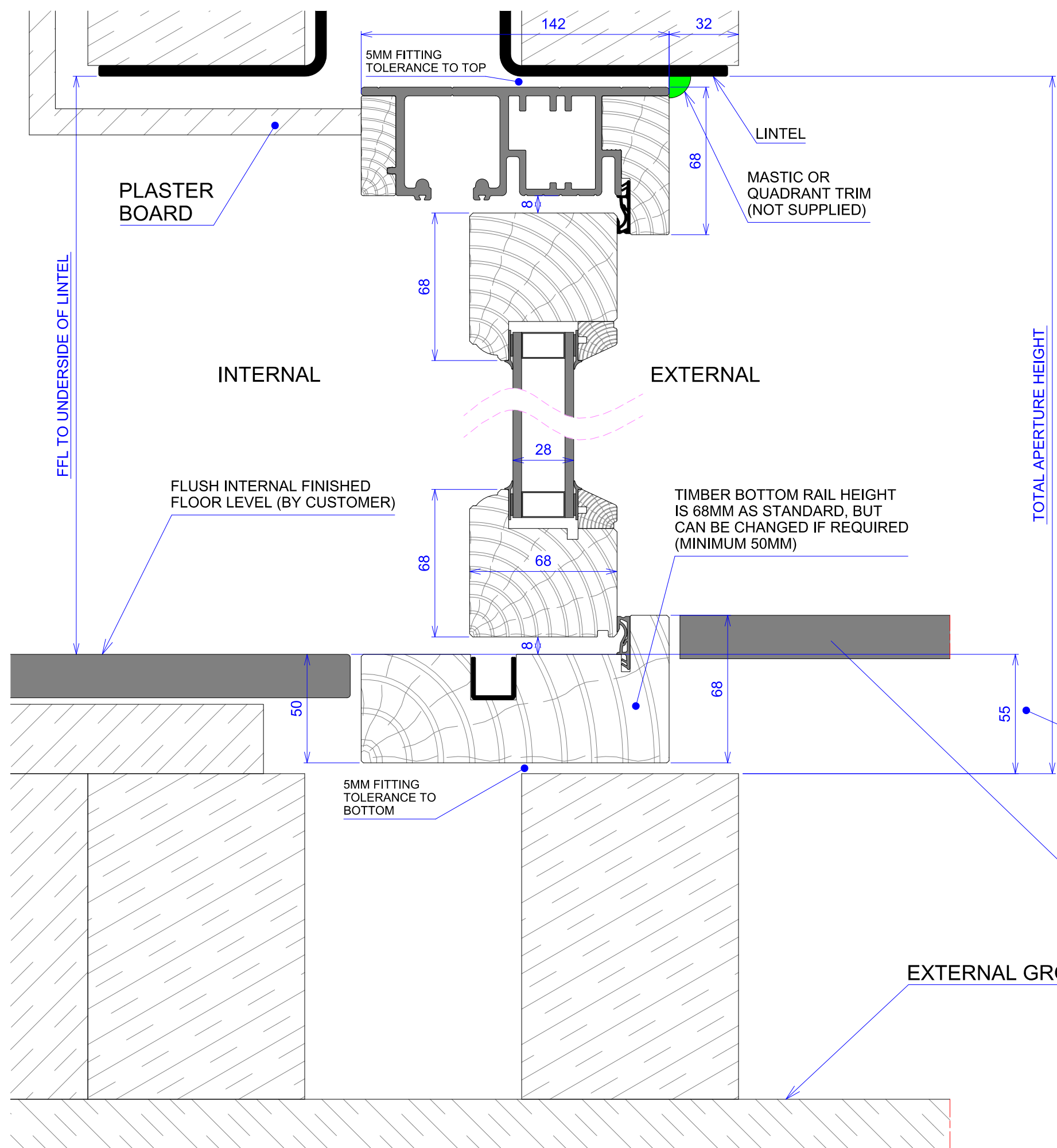

TO ACHIEVE A FLUSH FLOOR LEVEL INTERNALLY, THE CUSTOMER CAN EITHER BUILD THE FLOOR LEVEL UP OR REMOVE BOTTOM BRICKS AND INCREASE THE OVERALL FRAME HEIGHT TO SUIT

EITHER SPECIFY TOTAL APERTURE HEIGHT OR FROM UNDERSIDE OF LINTEL TO INTENDED INTERNAL FINISHED FLOOR LEVEL

THIS SILL TYPE IS MAINLY SUITABLE FOR SHELTERED LOCATIONS ONLY

IF THE LOCATION IS NOT SHELTERED CUSTOMER MUST MAKE THEIR OWN PROVISIONS FOR SILL DRAINAGE

ALLOW AT LEAST BOTTOM RAIL HEIGHT PLUS 5MM BELOW INTERNAL FFL FOR FRAME BOTTOM RAIL

EXTERNAL DECKING OR PATIO (BY CUSTOMER)

EXTERNAL GROUND

ALL SECTIONS SHOWN ARE OF A TYPICAL INSTALLATION. REQUIREMENTS MAY CHANGE DEPENDING ON INDIVIDUAL SITE CONDITIONS.

	BIFOLD DOORS	AUTHOR Luke Wynder		
		DATE 02/05/2012		
	VERTICAL CROSS SECTION			
A3	OPEN IN - SILL OPTION = 4			01

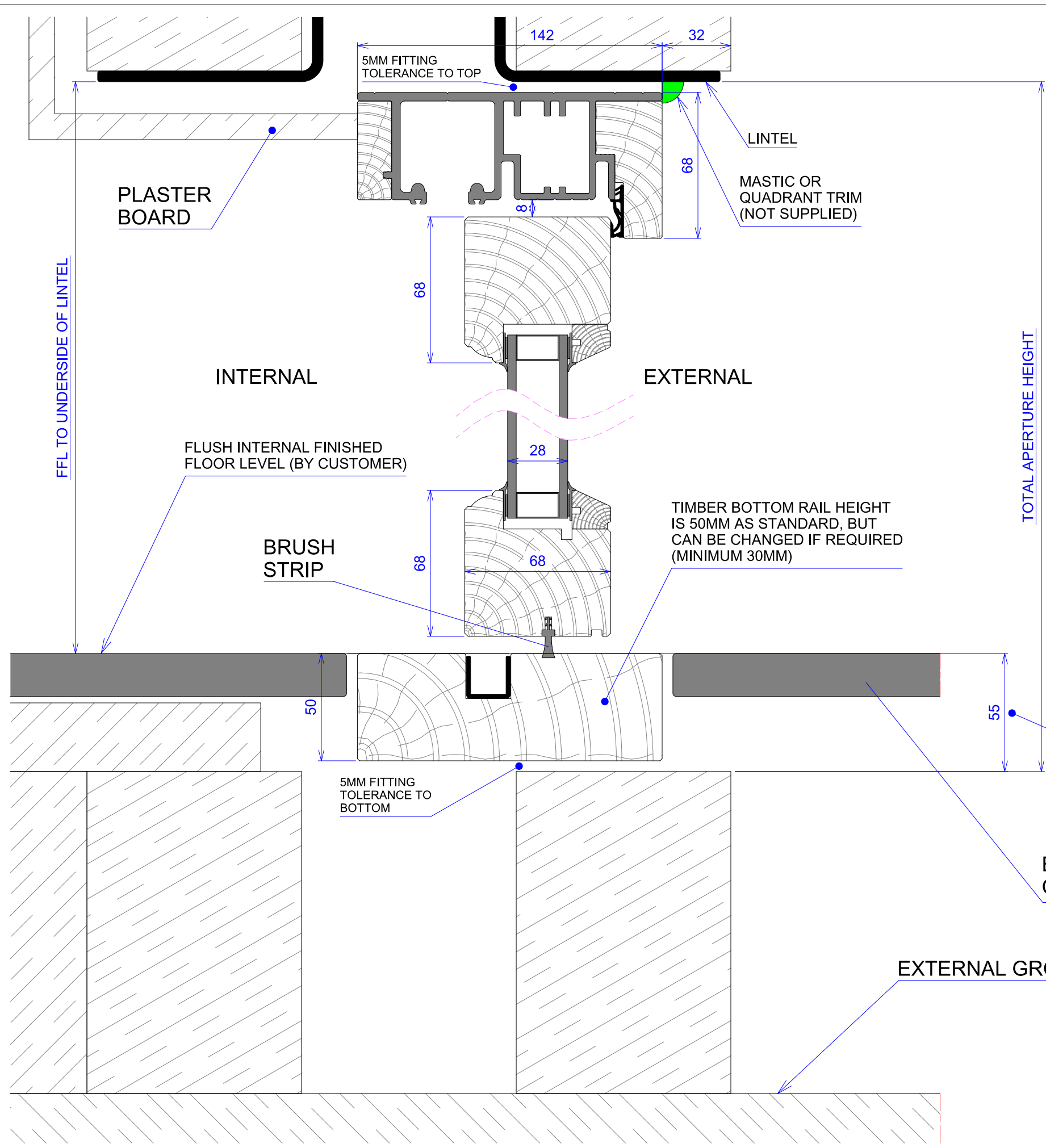

TO ACHIEVE A FLUSH FLOOR LEVEL INTERNALLY, THE CUSTOMER CAN EITHER BUILD THE FLOOR LEVEL UP OR REMOVE BOTTOM BRICKS AND INCREASE THE OVERALL FRAME HEIGHT TO SUIT

EITHER SPECIFY TOTAL APERTURE HEIGHT OR FROM UNDERSIDE OF LINTEL TO INTENDED INTERNAL FINISHED FLOOR LEVEL

THIS SILL TYPE IS MAINLY SUITABLE FOR SHELTERED LOCATIONS ONLY

THE BRUSH STIPS IN THE BOTTOM OF THE DOORS MAY NOT FULLY MEET AT EDGES OF DOORS

THE DOORS MAY ALSO HAVE A FEW MM OF PLAY AT THE BOTTOM DUE TO THE ABSENCE OF THE LOWER INTERNAL SEAL STOP UPSTAND FOR THE DOORS TO CLOSE AGAINST

IF THE LOCATION IS NOT SHELTERED CUSTOMER MUST MAKE THEIR OWN PROVISIONS FOR SILL DRAINAGE AND WEATHER PROOFING

ALLOW AT LEAST BOTTOM RAIL HEIGHT PLUS 5MM BELOW INTERNAL FFL FOR FRAME BOTTOM RAIL

ALL SECTIONS SHOWN ARE OF A TYPICAL INSTALLATION. REQUIREMENTS MAY CHANGE DEPENDING ON INDIVIDUAL SITE CONDITIONS.

	BIFOLD DOORS	AUTHOR Luke Wynder		
		DATE 02/05/2012		
A3	VERTICAL CROSS SECTION			
	OPEN IN - SILL OPTION = 5			

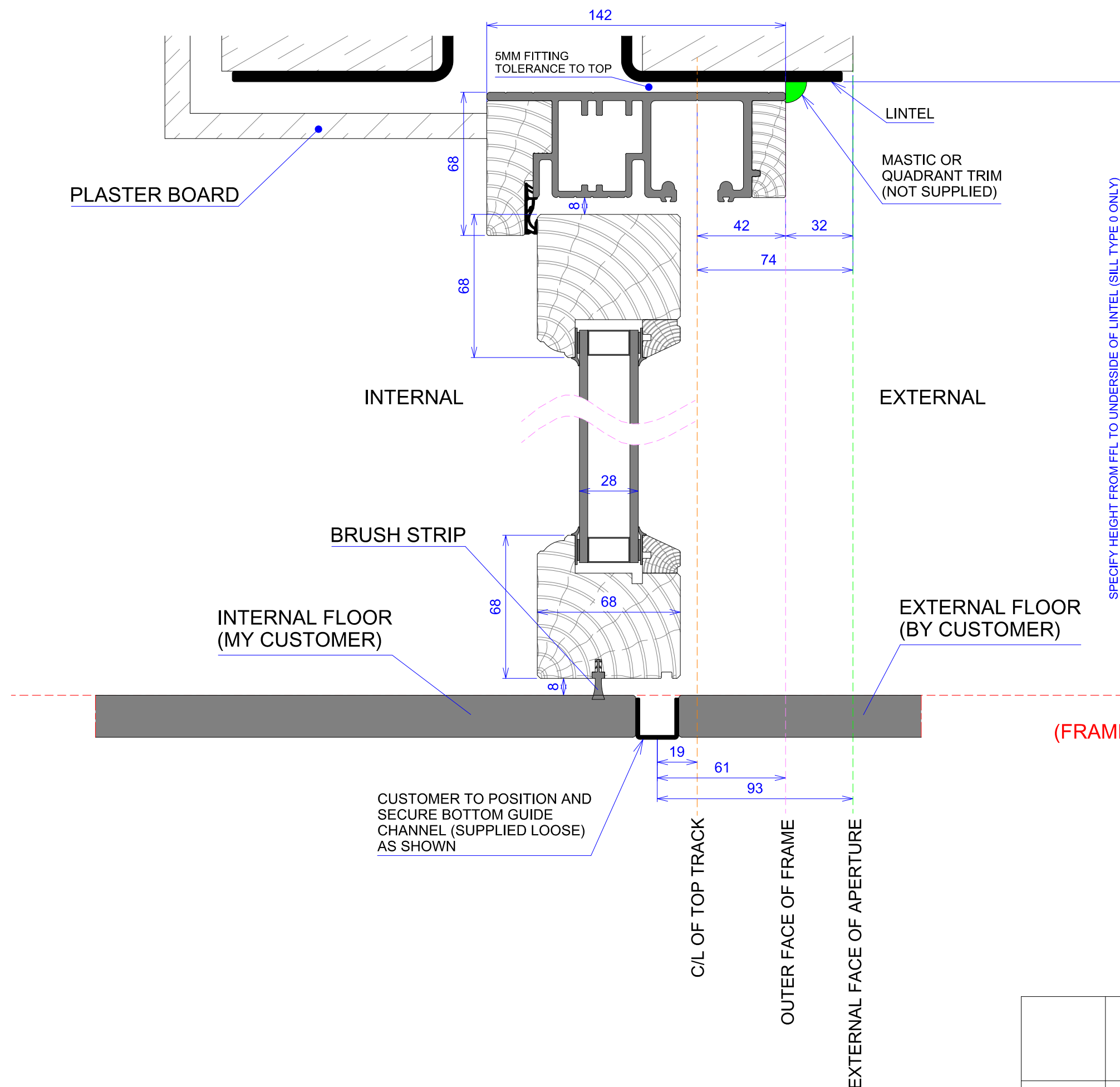

NOTE THAT THE KEEPS PROVIDED LOOSE FOR THE LOWER SHOOT BOLTS ARE TO BE POSITIONED AND FIXED WHERE NECESSARY BY THE CUSTOMER

THE FLOOR WILL REQUIRE ROUTING OUT TO ALLOW THE SHOOT BOLTS TO FULLY EXTEND TO THEIR CLOSED POSITION

THIS SILL TYPE IS MAINLY SUITABLE FOR SHELTERED LOCATIONS ONLY

IF THE LOCATION IS NOT SHELTERED CUSTOMER MUST MAKE THEIR OWN PROVISIONS FOR SILL DRAINAGE AND WEATHER PROOFING

ALL SECTIONS SHOWN ARE OF A TYPICAL INSTALLATION. REQUIREMENTS MAY CHANGE DEPENDING ON INDIVIDUAL SITE CONDITIONS.

	BIFOLD DOORS	AUTHOR Luke Wynder		
		DATE 02/05/2012		
	VERTICAL CROSS SECTION			
A3	OPEN OUT - SILL OPTION = 0			01

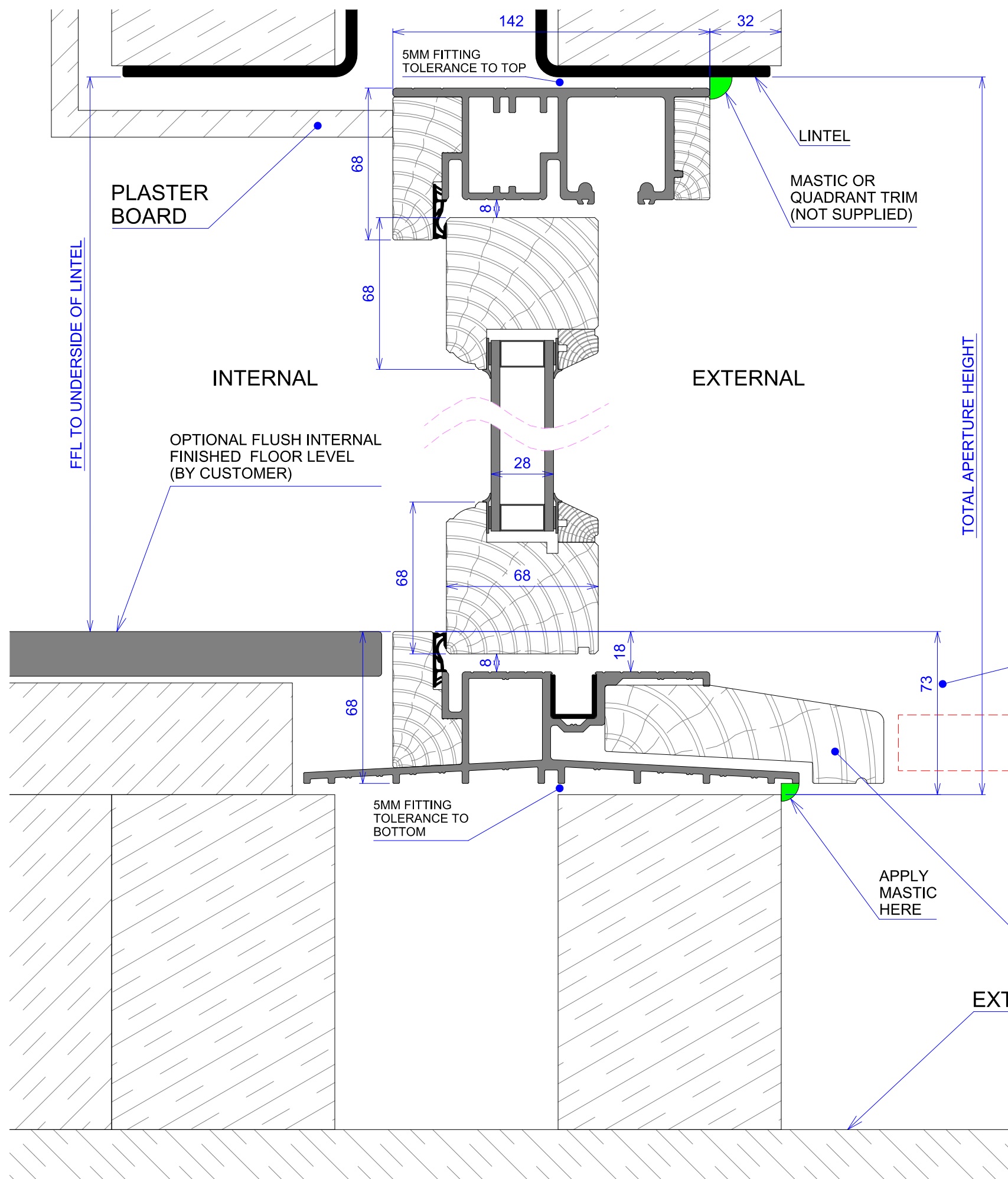

IF A FLUSH FLOOR LEVEL IS REQUIRED INTERNALLY, THE CUSTOMER CAN EITHER BUILD THE FLOOR LEVEL UP OR REMOVE BOTTOM BRICKS AND INCREASE THE OVERALL FRAME HEIGHT TO SUIT

EITHER SPECIFY TOTAL APERTURE HEIGHT OR FROM UNDERSIDE OF LINTEL TO INTENDED INTERNAL FINISHED FLOOR LEVEL

IF FLUSH INTERNAL FLOOR LEVEL IS REQUIRED WITH WITH SILL TYPE 1, ALLOW AT LEAST 73MM BELOW FFL FOR FRAME BOTTOM RAIL

TIMBER SILL WILL BE SENT 100MM OVER LENGTH TO HAVE HORNS CUT AROUND BRICK TO SUIT ON SITE (CUSTOMER TO SPECIFY IF DIFFERENT IS REQUIRED)

OPTIONAL EXTERNAL DECKING OR PATIO BY CUSTOMER

EXTERNAL GROUND

ALL SECTIONS SHOWN ARE OF A TYPICAL INSTALLATION. REQUIREMENTS MAY CHANGE DEPENDING ON INDIVIDUAL SITE CONDITIONS.

	BIFOLD DOORS	AUTHOR Luke Wynder		
		DATE 02/05/2012		
	VERTICAL CROSS SECTION			
A3	OPEN OUT - SILL OPTION = 1			01

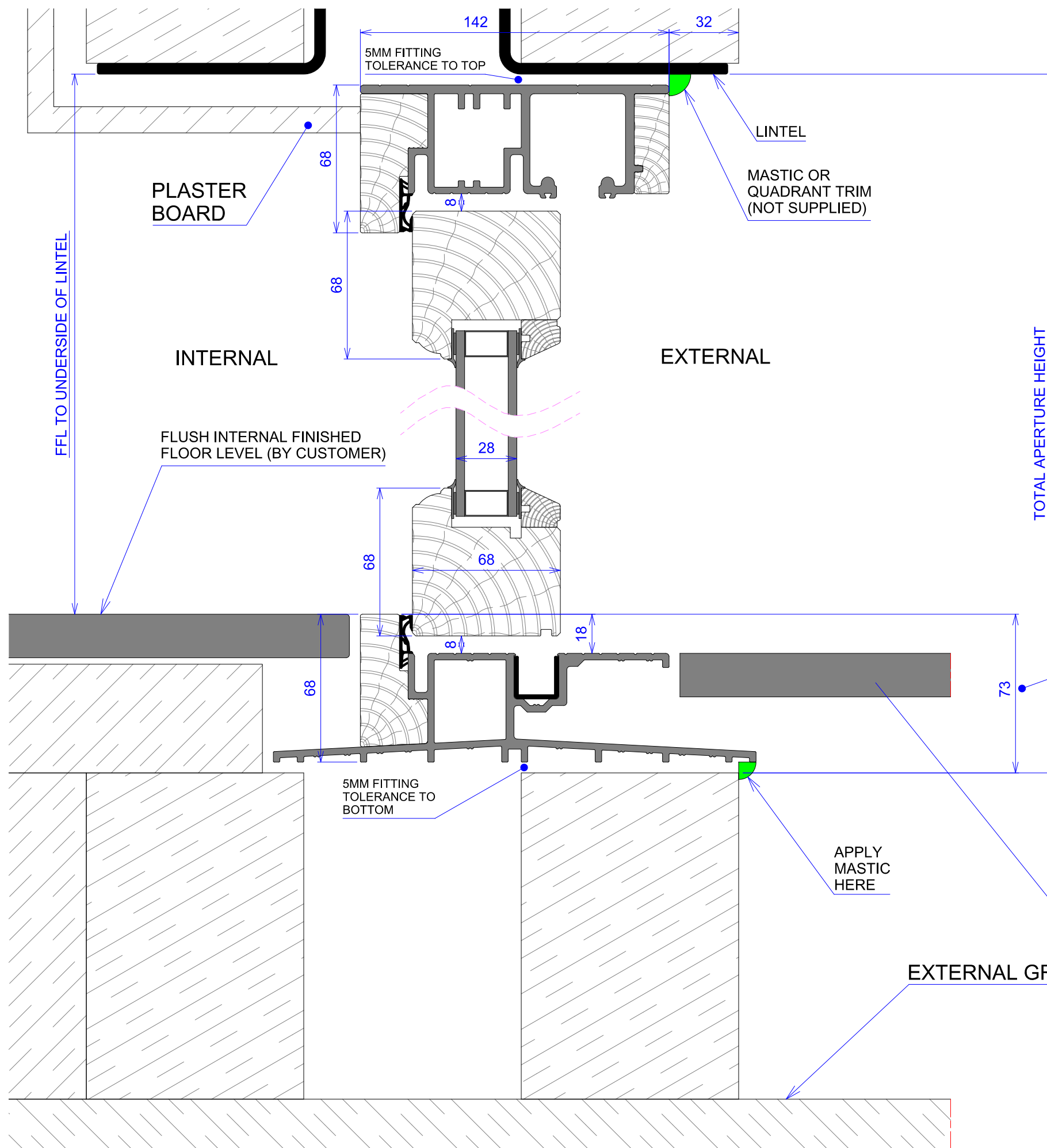

TO ACHIEVE A FLUSH FLOOR LEVEL INTERNALLY, THE CUSTOMER CAN EITHER BUILD THE FLOOR LEVEL UP OR REMOVE BOTTOM BRICKS AND INCREASE THE OVERALL FRAME HEIGHT TO SUIT

EITHER SPECIFY TOTAL APERTURE HEIGHT OR FROM UNDERSIDE OF LINTEL TO INTENDED INTERNAL FINISHED FLOOR LEVEL

ALLOW AT LEAST 73MM BELOW INTERNAL FFL FOR FRAME BOTTOM RAIL

ALL SECTIONS SHOWN ARE OF A TYPICAL INSTALLATION.
REQUIREMENTS MAY CHANGE DEPENDING ON INDIVIDUAL SITE CONDITIONS.

	BIFOLD DOORS	AUTHOR Luke Wynder		
		DATE 02/05/2012		
A3	VERTICAL CROSS SECTION			
	OPEN OUT - SILL OPTION = 2			
				01

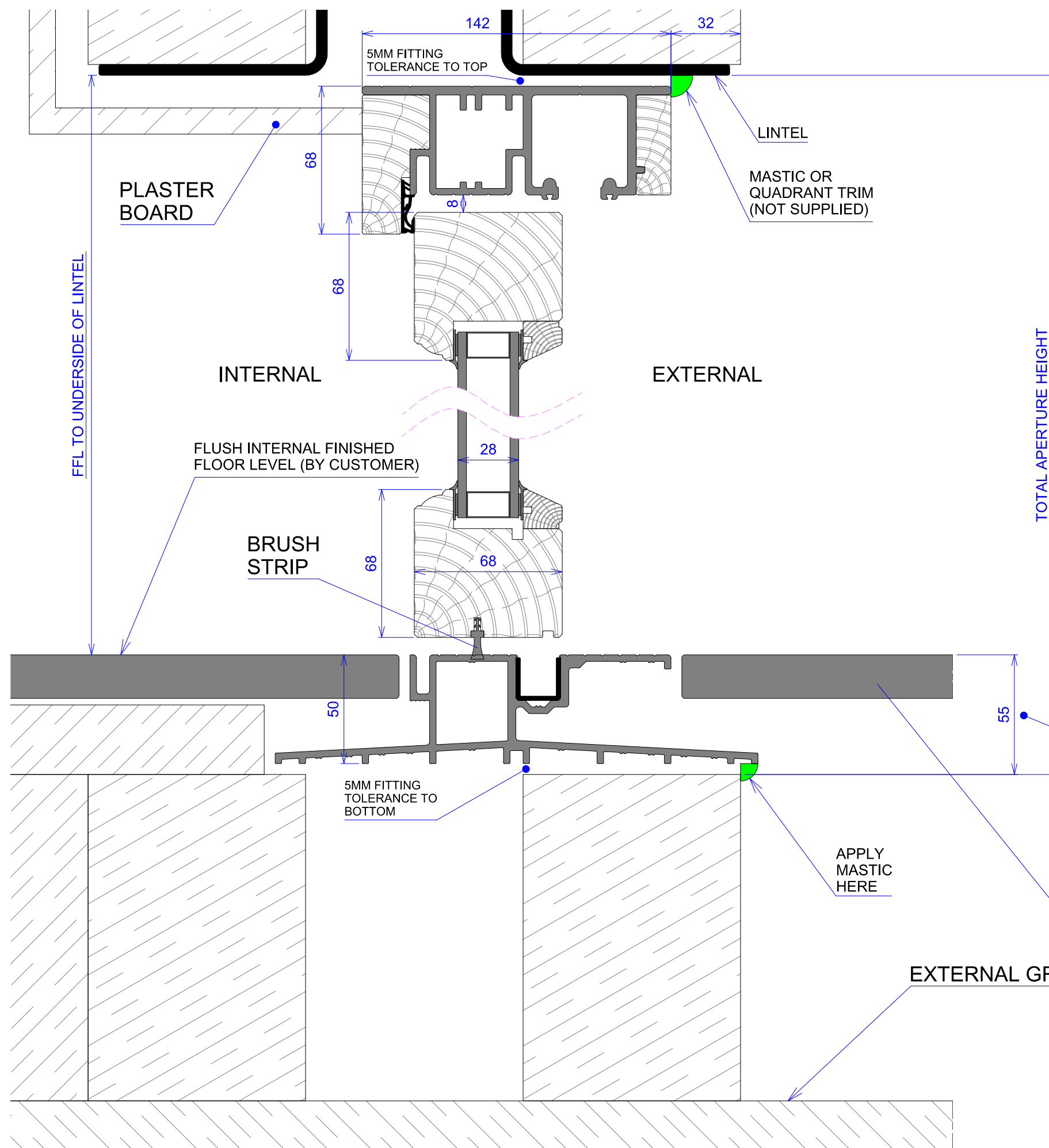

TO ACHIEVE A FLUSH FLOOR LEVEL INTERNALLY, THE CUSTOMER CAN EITHER BUILD THE FLOOR LEVEL UP OR REMOVE BOTTOM BRICKS AND INCREASE THE OVERALL FRAME HEIGHT TO SUIT

EITHER SPECIFY TOTAL APERTURE HEIGHT OR FROM UNDERSIDE OF LINTEL TO INTENDED INTERNAL FINISHED FLOOR LEVEL

THIS SILL OPTION IS MAINLY SUITABLE FOR SHELTERED LOCATIONS ONLY

THE BRUSH STIPS IN THE BOTTOM OF THE DOORS MAY NOT FULLY MEET AT EDGES OF DOORS

THE DOORS MAY ALSO HAVE A FEW MM OF PLAY AT THE BOTTOM DUE TO THE ABSENCE OF THE LOWER INTERNAL SEAL STOP UPSTAND FOR THE DOORS TO CLOSE AGAINST

ALLOW AT LEAST 55MM BELOW INTERNAL FFL FOR FRAME BOTTOM RAIL

ALL SECTIONS SHOWN ARE OF A TYPICAL INSTALLATION.
REQUIREMENTS MAY CHANGE DEPENDING ON INDIVIDUAL SITE CONDITIONS.

	BIFOLD DOORS	AUTHOR Luke Wynder		
		DATE 02/05/2012		
	VERTICAL CROSS SECTION			
A3	OPEN OUT - SILL OPTION = 3			01

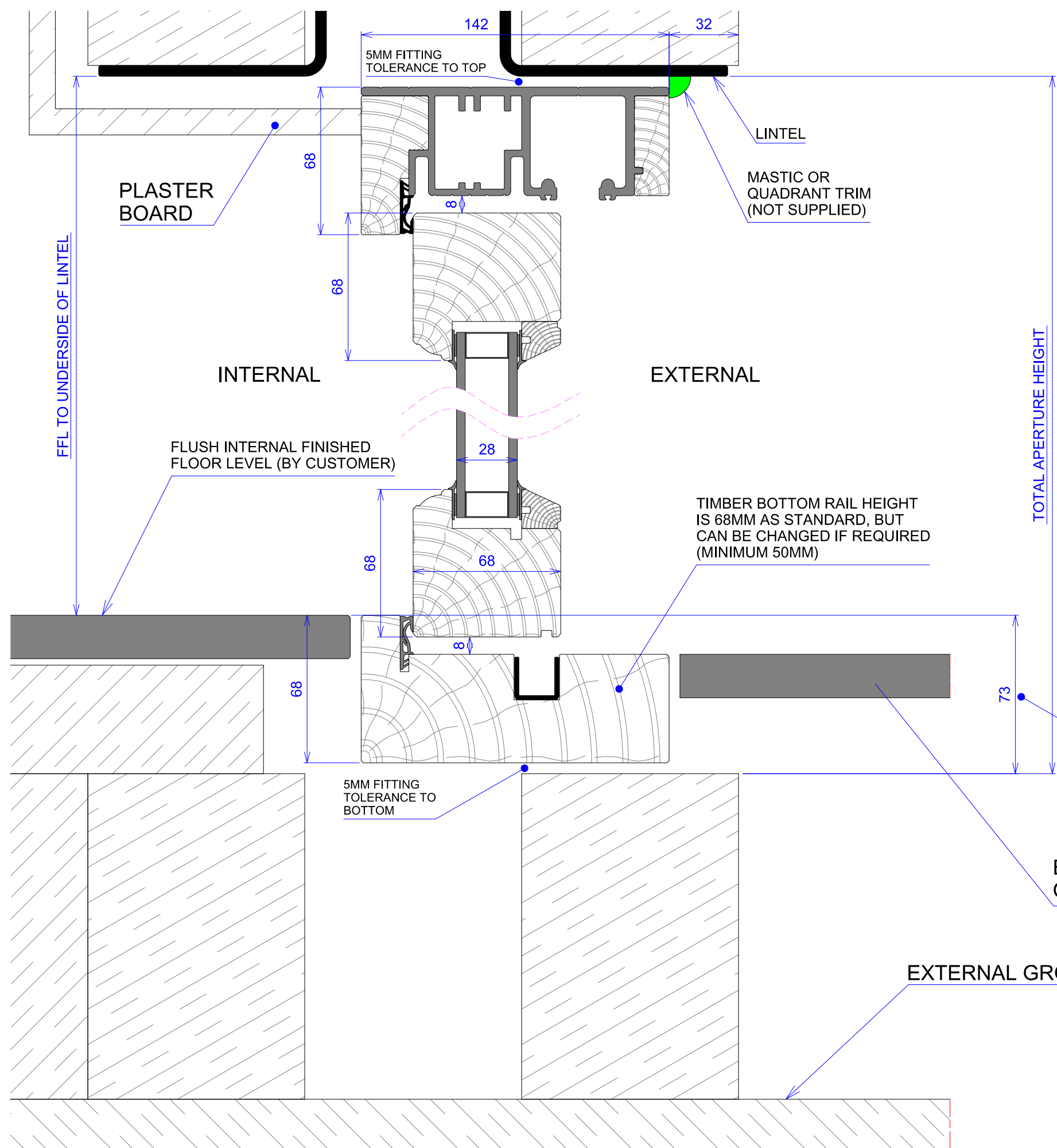

TO ACHIEVE A FLUSH FLOOR LEVEL INTERNALLY, THE CUSTOMER CAN EITHER BUILD THE FLOOR LEVEL UP OR REMOVE BOTTOM BRICKS AND INCREASE THE OVERALL FRAME HEIGHT TO SUIT

EITHER SPECIFY TOTAL APERTURE HEIGHT OR FROM UNDERSIDE OF LINTEL TO INTENDED INTERNAL FINISHED FLOOR LEVEL

NOTE THAT THE KEEPS PROVIDED LOOSE FOR THE LOWER SHOOT BOLTS ARE TO BE POSITIONED AND FIXED WHERE NECESSARY BY THE CUSTOMER

THE FRAME BOTTOM RAIL WILL REQUIRE ROUTING OUT TO ALLOW THE SHOOT BOLTS TO FULLY EXTEND TO THEIR CLOSED POSITION

THIS SILL TYPE IS MAINLY SUITABLE FOR SHELTERED LOCATIONS ONLY

IF THE LOCATION IS NOT SHELTERED CUSTOMER MUST MAKE THEIR OWN PROVISIONS FOR SILL DRAINAGE

ALLOW AT LEAST BOTTOM RAIL HEIGHT PLUS 5MM BELOW INTERNAL FFL FOR FRAME BOTTOM RAIL

EXTERNAL DECKING OR PATIO (BY CUSTOMER)

EXTERNAL GROUND

ALL SECTIONS SHOWN ARE OF A TYPICAL INSTALLATION. REQUIREMENTS MAY CHANGE DEPENDING ON INDIVIDUAL SITE CONDITIONS.

	BIFOLD DOORS	AUTHOR Luke Wynder		
		DATE 02/05/2012		
	VERTICAL CROSS SECTION			
A3	OPEN OUT - SILL OPTION = 4			01

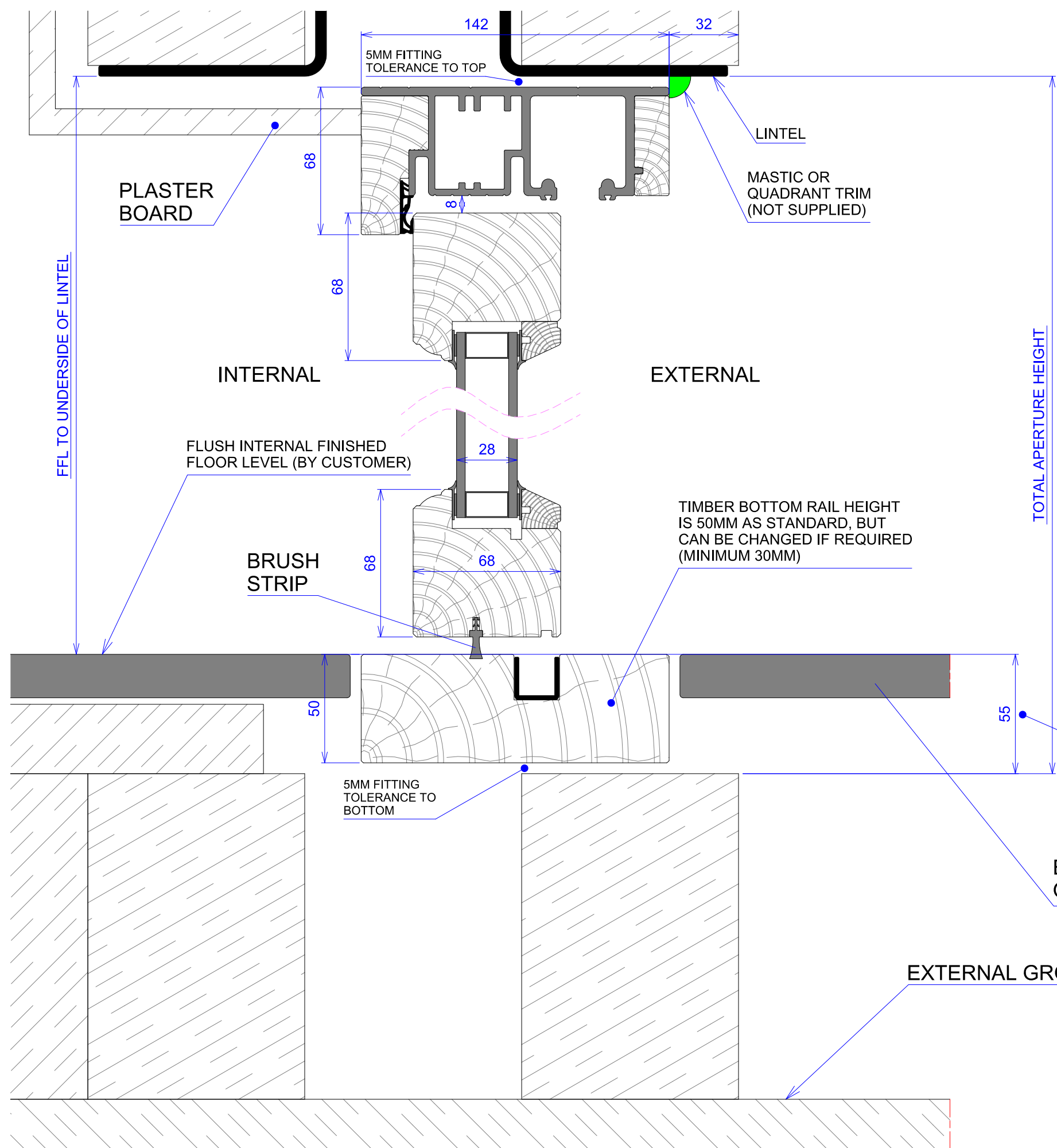

TO ACHIEVE A FLUSH FLOOR LEVEL INTERNALLY, THE CUSTOMER CAN EITHER BUILD THE FLOOR LEVEL UP OR REMOVE BOTTOM BRICKS AND INCREASE THE OVERALL FRAME HEIGHT TO SUIT

EITHER SPECIFY TOTAL APERTURE HEIGHT OR FROM UNDERSIDE OF LINTEL TO INTENDED INTERNAL FINISHED FLOOR LEVEL

NOTE THAT THE KEEPS PROVIDED LOOSE FOR THE LOWER SHOOT BOLTS ARE TO BE POSITIONED AND FIXED WHERE NECESSARY BY THE CUSTOMER

THE FRAME BOTTOM RAIL WILL REQUIRE ROUTING OUT TO ALLOW THE SHOOT BOLTS TO FULLY EXTEND TO THEIR CLOSED POSITION

THIS SILL TYPE IS MAINLY SUITABLE FOR SHELTERED LOCATIONS ONLY

THE BRUSH STIPS IN THE BOTTOM OF THE DOORS MAY NOT FULLY MEET AT EDGES OF DOORS

THE DOORS MAY ALSO HAVE A FEW MM OF PLAY AT THE BOTTOM DUE TO THE ABSENCE OF THE LOWER INTERNAL SEAL STOP UPSTAND FOR THE DOORS TO CLOSE AGAINST

IF THE LOCATION IS NOT SHELTERED CUSTOMER MUST MAKE THEIR OWN PROVISIONS FOR SILL DRAINAGE AND WEATHER PROOFING

ALLOW AT LEAST BOTTOM RAIL HEIGHT PLUS 5MM BELOW INTERNAL FFL FOR FRAME BOTTOM RAIL

EXTERNAL DECKING OR PATIO (BY CUSTOMER)

EXTERNAL GROUND

ALL SECTIONS SHOWN ARE OF A TYPICAL INSTALLATION. REQUIREMENTS MAY CHANGE DEPENDING ON INDIVIDUAL SITE CONDITIONS.

	BIFOLD DOORS	AUTHOR Luke Wynder		
		DATE 02/05/2012		
	VERTICAL CROSS SECTION			
A3	OPEN OUT - SILL OPTION = 5			01

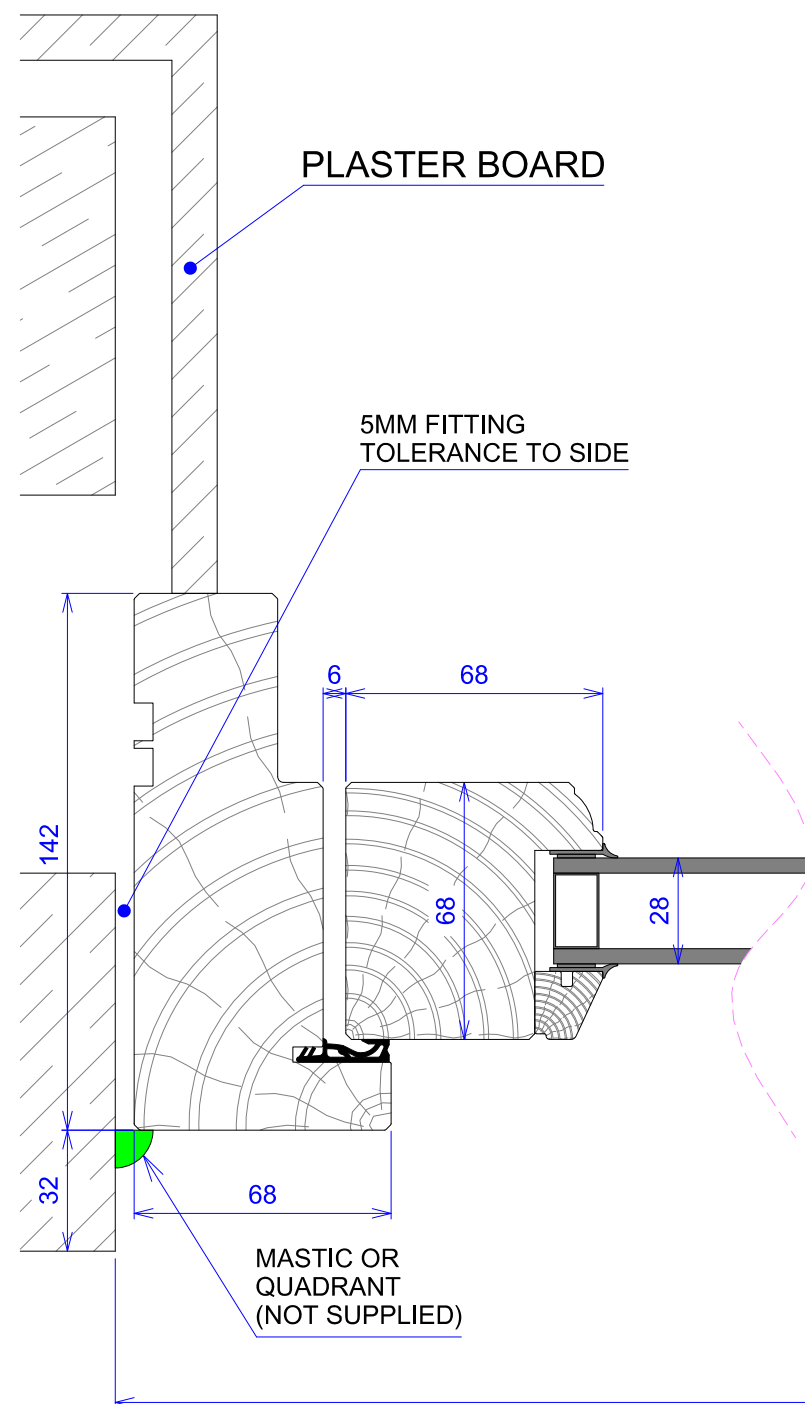

INTERNAL

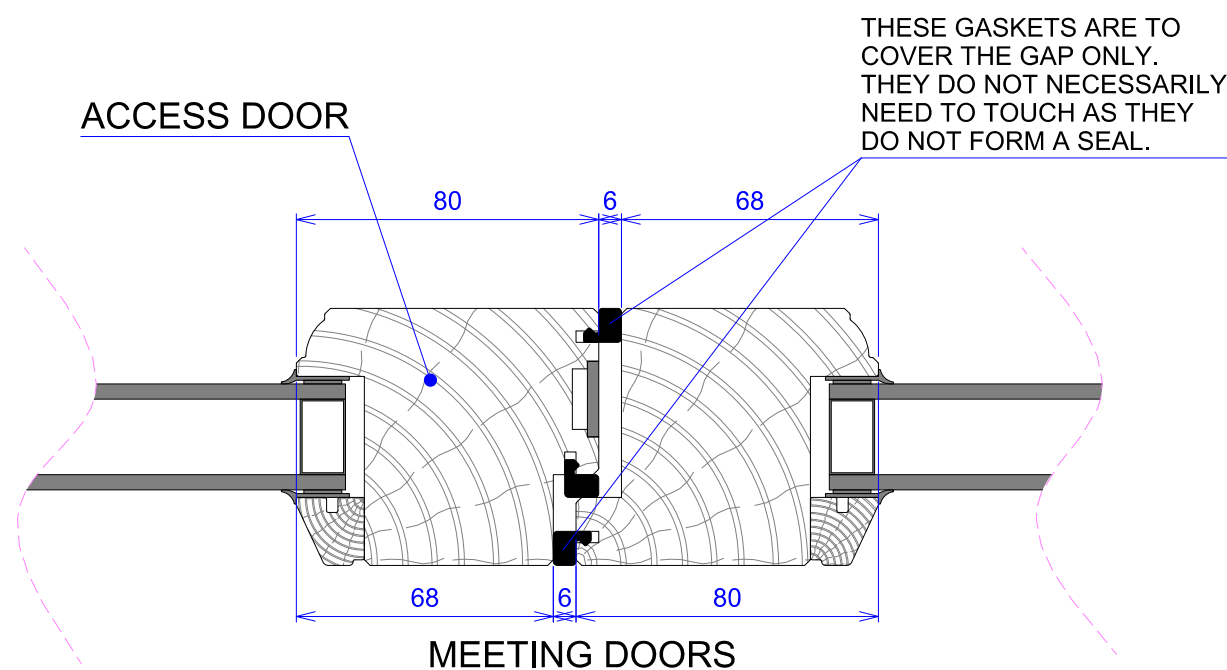

IF THE ACCESS DOOR CHANGES POSITION OR THE CONFIGURATION IS OPPOSITE TO THAT SHOWN, THE REBATES, GASKETS AND LOCK POSITION ON THE MEETING DOORS WILL BE THE OPPOSITE HAND TO THOSE ABOVE.

EXTERNAL

APERTURE WIDTH

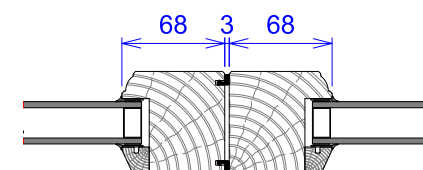
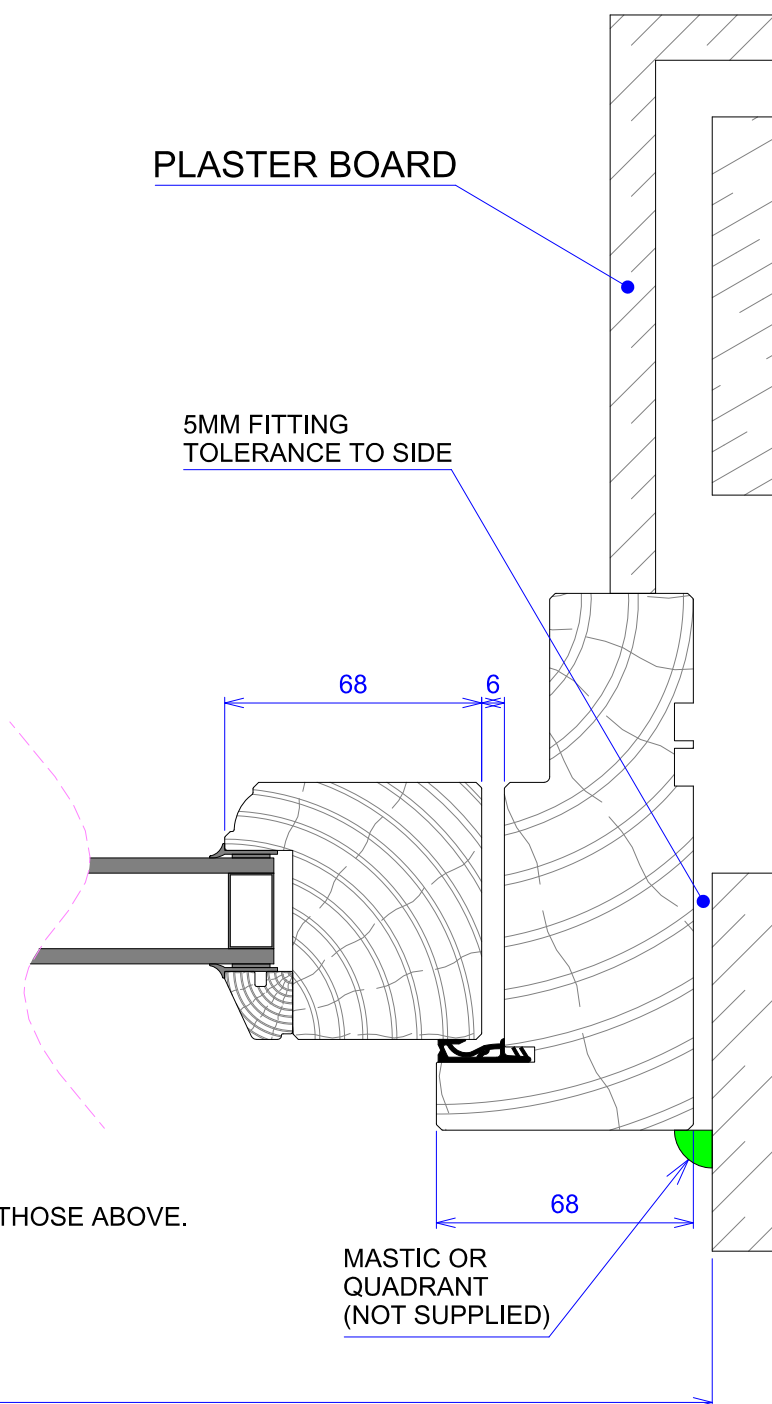

ALL OTHER LINKING DOOR GAPS ARE 3MM

PLEASE SEE ADDITIONAL NOTES FOR INFO ON TIMBER SIZES, DOOR CONFIGURATIONS, GAPS AND ACCESS DOOR OPTIONS.

ON ODD / ODD SETS THE ACCESS DOOR IS ON THE LEFT AS DEFAULT. IT CAN BE CHANGED TO THE RIGHT DOOR UPON REQUEST.

ON ODD / EVEN SETS THE ACCESS DOOR IS ALWAYS THE ODD DOOR.

ON SETS WHERE ONE OF THE STACKS IS A SINGLE DOOR (ONE), THIS WILL BE THE ACCESS DOOR BY DEFAULT. IF THE OTHER STACK IS ALSO ODD, THE ACCESS DOOR CAN BE CHANGED UPON REQUEST.

ALL ACCESS DOOR SIDES SPECIFIED ARE AS IF VIEWED FROM THE OUTSIDE.

THE GAPS SHOWN ARE AS A GUIDANCE ONLY. DUE TO THE NATURAL MOVEMENT OF TIMBER, THEY MAY DIFFER SLIGHTLY FROM THOSE SHOWN.

ALL GAPS ARE ADJUSTABLE (APART FROM THE 3MM LINKING DOOR GAPS) AND SHOULD BE ADJUSTED AS NECESSARY BY THE INSTALLER TO ENSURE CORRECT OPERATION.

	BIFOLD DOORS	AUTHOR Luke Wynder		
		DATE 03/05/2012		
	HORIZONTAL CROSS SECTION - OPEN IN			
A3	TYPICAL OPEN IN CROSS SECTION			01

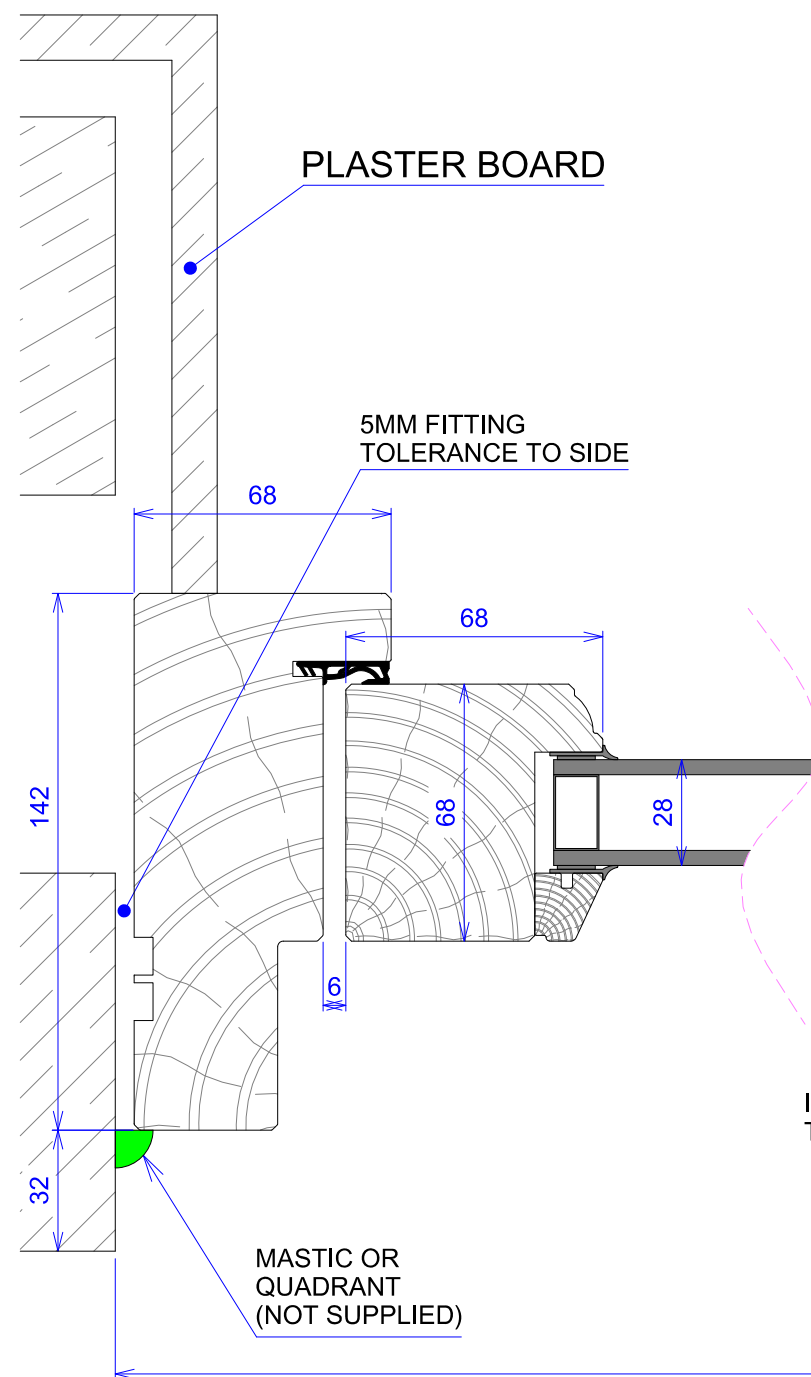

INTERNAL

ACCESS DOOR
(SEE NOTES BELOW)

THESE GASKETS ARE TO
COVER THE GAP ONLY.
THEY DO NOT NECESSARILY
NEED TO TOUCH AS THEY
DO NOT FORM A SEAL.

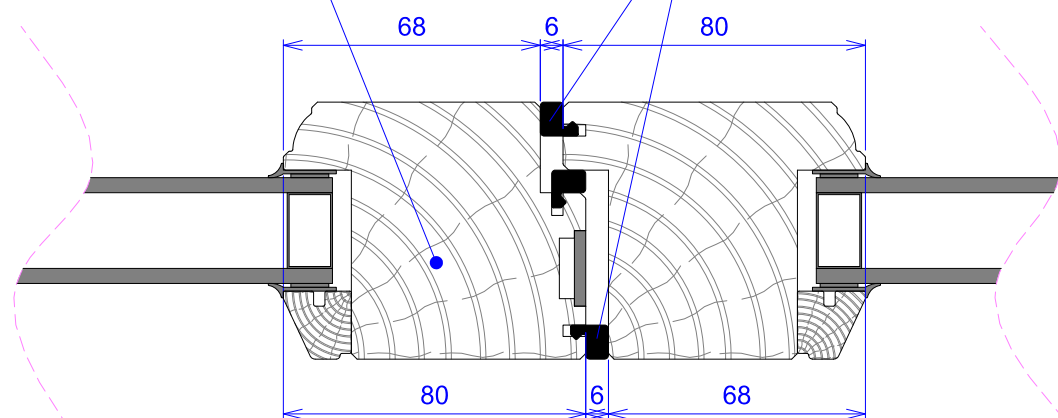

MEETING DOORS

IF THE ACCESS DOOR CHANGES POSITION OR THE CONFIGURATION IS OPPOSITE TO THAT SHOWN,
THE REBATES, GASKETS AND LOCK POSITION ON THE MEETING DOORS WILL BE THE OPPOSITE HAND TO THOSE ABOVE.

EXTERNAL

APERTURE WIDTH

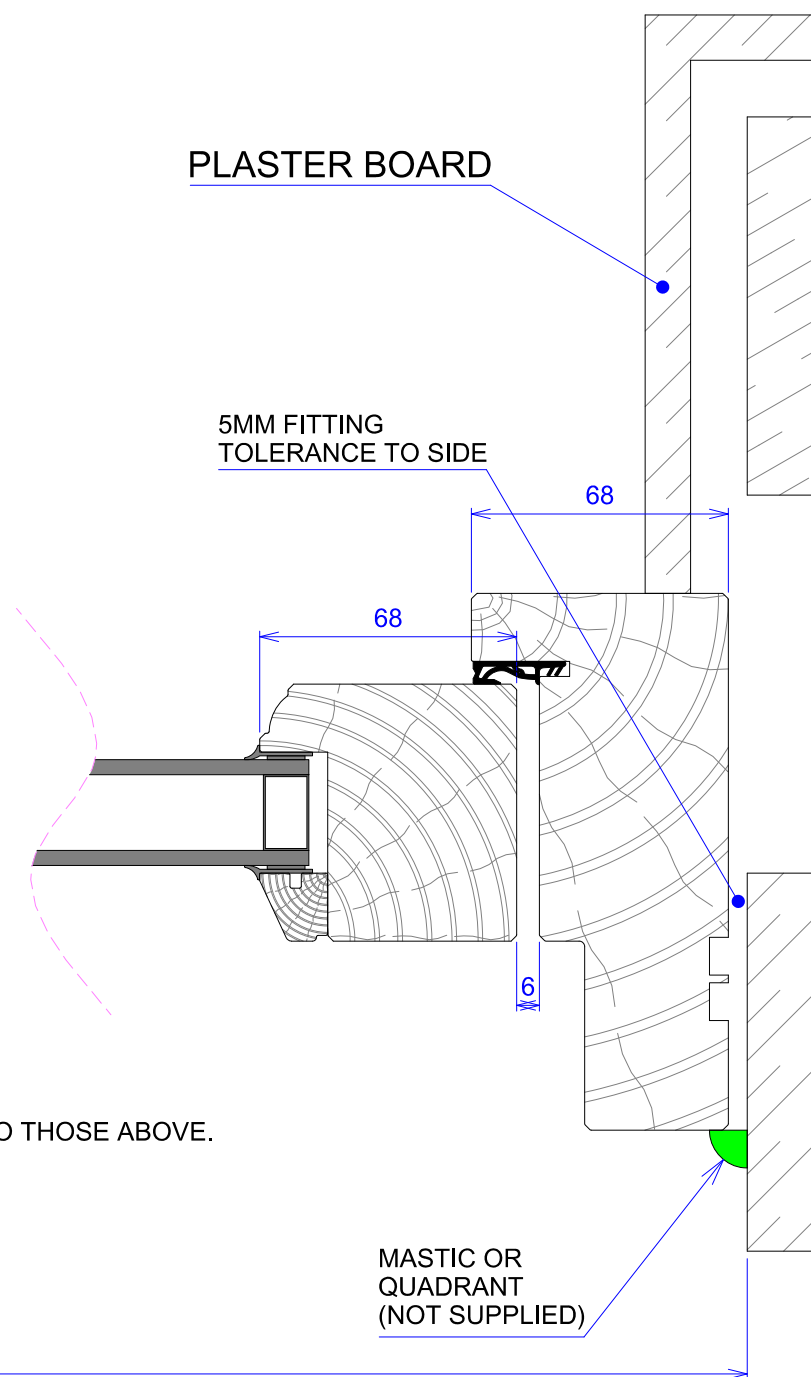

PLEASE SEE ADDITIONAL NOTES FOR INFO ON TIMBER SIZES,
DOOR GONFIGURATIONS, GAPS AND ACCESS DOOR OPTIONS.

ON ODD / ODD SETS THE ACCESS DOOR IS ON THE LEFT AS DEFAULT.
IT CAN BE CHANGED TO THE RIGHT DOOR UPON REQUEST.

ON ODD / EVEN SETS THE ACCESS DOOR IS ALWAYS THE ODD DOOR.

ON SETS WHERE ONE OF THE STACKS IS A SINGLE DOOR (ONE), THIS WILL BE THE ACCESS DOOR BY DEFAULT.
IF THE OTHER STACK IS ALSO ODD, THE ACCESS DOOR CAN BE CHANGED UPON REQUEST.

ALL ACCESS DOOR SIDES SPECIFIED ARE AS IF VIEWED FROM THE OUTSIDE.

THE GAPS SHOWN ARE AS A GUIDANCE ONLY.
DUE TO THE NATURAL MOVEMENT OF TIMBER,
THEY MAY DIFFER SLIGHTLY FROM THOSE SHOWN.

ALL GAPS ARE ADJUSTABLE (APART FROM THE 3MM LINKING DOOR GAPS) AND SHOULD
BE ADJUSTED AS NECESSARY BY THE INSTALLER TO ENSURE CORRECT OPERATION.

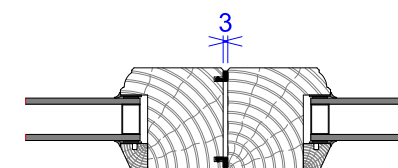

ALL OTHER LINKING DOOR GAPS ARE 3MM

	BIFOLD DOORS	AUTHOR Luke Wynder		
		DATE 03/05/2012		
	HORIZONTAL CROSS SECTION - OPEN OUT			
A3	ODD / ODD OR ODD / EVEN			01

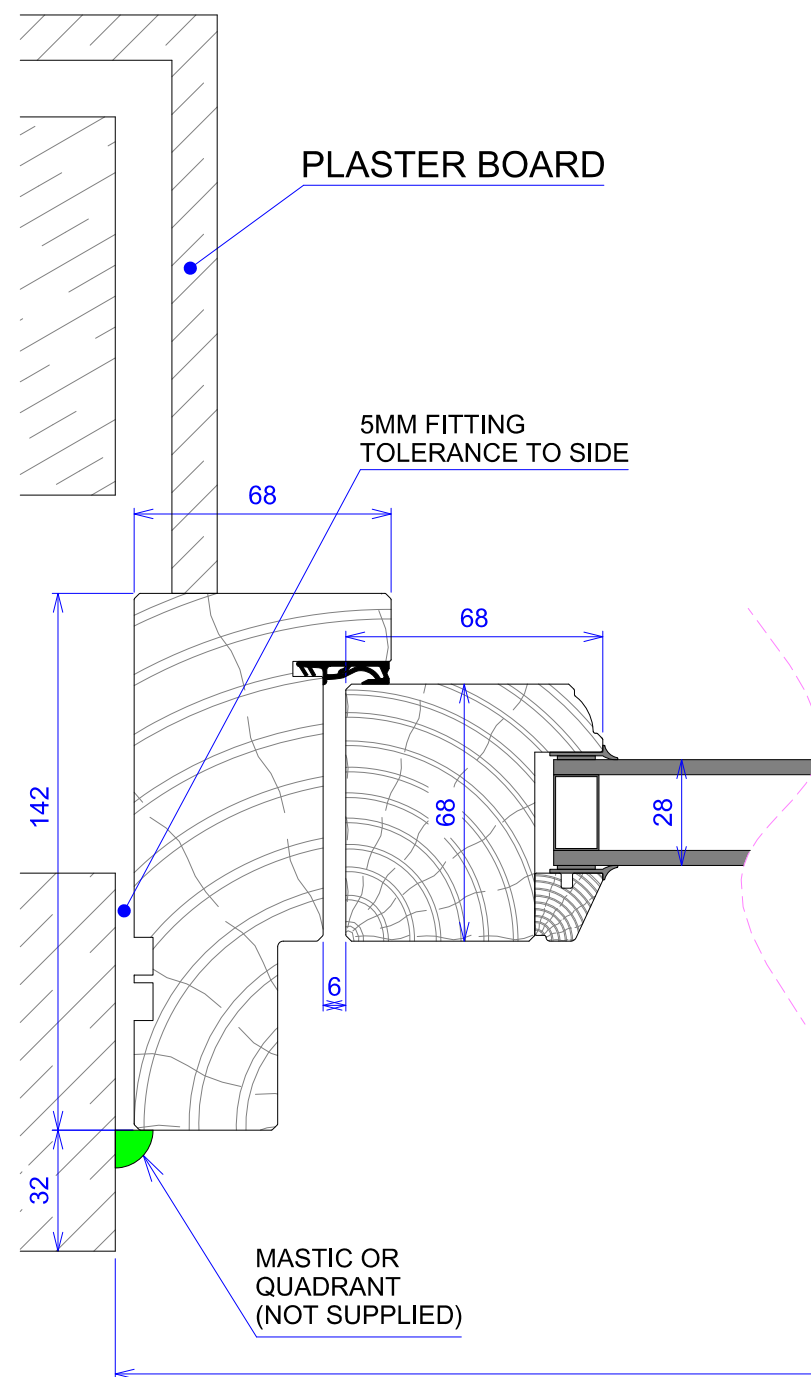

INTERNAL

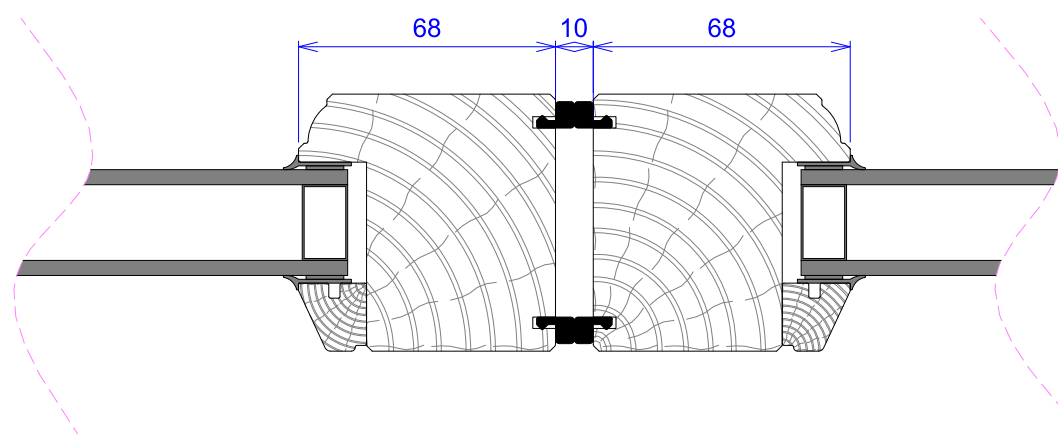

MEETING DOORS

EXTERNAL

APERTURE WIDTH

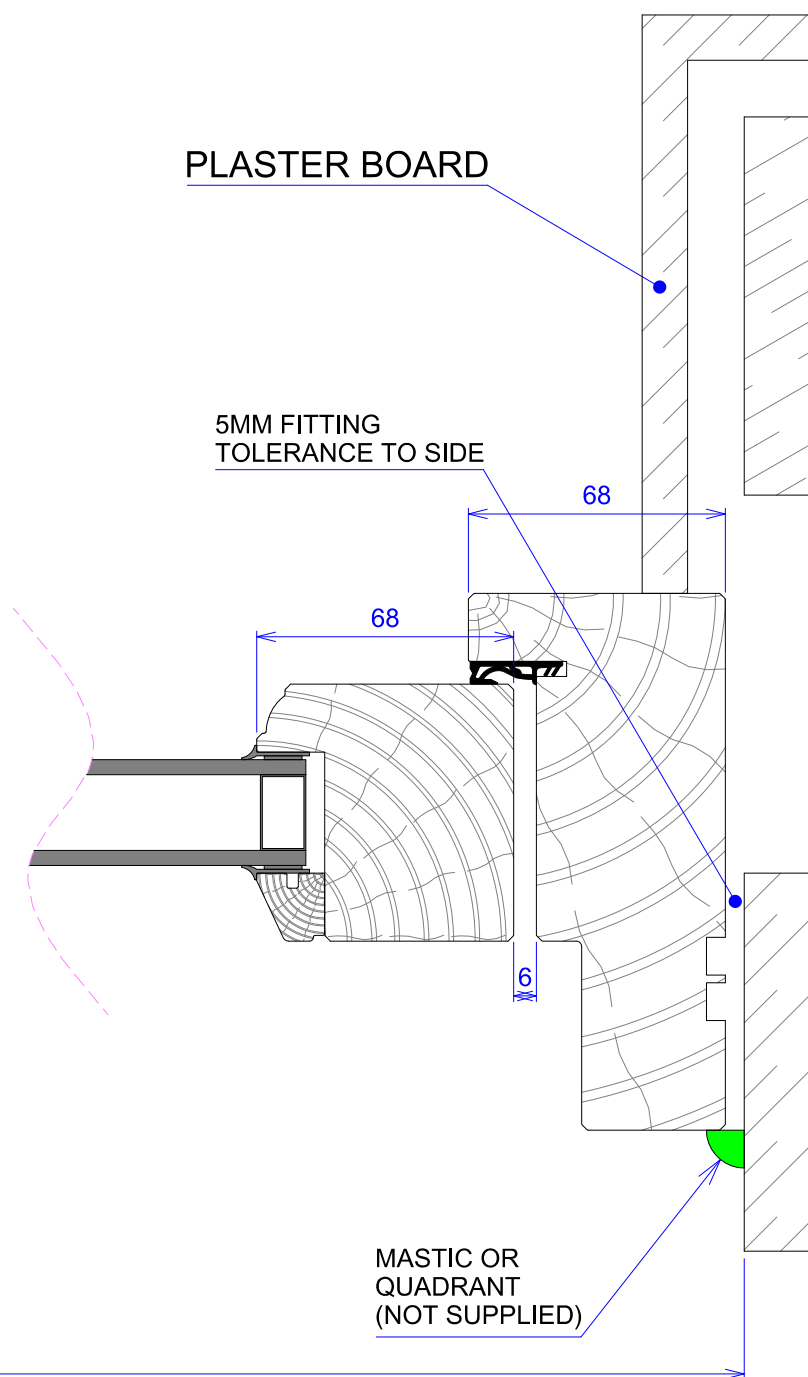

NO ACCESS DOOR (NO ACCESS FROM OUTSIDE POSSIBLE).

OPENING IS ACHIEVED BY UNBOLTING AND FOLDING AT LEAST 2 OF THE DOORS FROM THE INSIDE.

LOCKS AND HANDLES ARE NOT REQUIRED ON THIS CONFIGURATION AS EACH STACK IS EVEN AND THEREFORE TERMINATES ON ROLLERS INTO THE TRACKS.

PLEASE SEE ADDITIONAL NOTES FOR INFO ON TIMBER SIZES, DOOR GONFIGURATIONS, GAPS AND ACCESS DOOR OPTIONS.

THE GAPS SHOWN ARE AS A GUIDANCE ONLY. DUE TO THE NATURAL MOVEMENT OF TIMBER, THEY MAY DIFFER SLIGHTLY FROM THOSE SHOWN.

ALL GAPS ARE ADJUSTABLE (APART FROM THE 3MM LINKING DOOR GAPS) AND SHOULD BE ADJUSTED AS NECESSARY BY THE INSTALLER TO ENSURE CORRECT OPERATION.

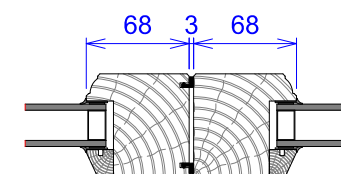

ALL OTHER LINKING DOOR GAPS ARE 3MM

	BIFOLD DOORS	AUTHOR Luke Wynder		
		DATE 03/05/2012		
	HORIZONTAL CROSS SECTION - OPEN OUT			
A3	EVEN / EVEN			01

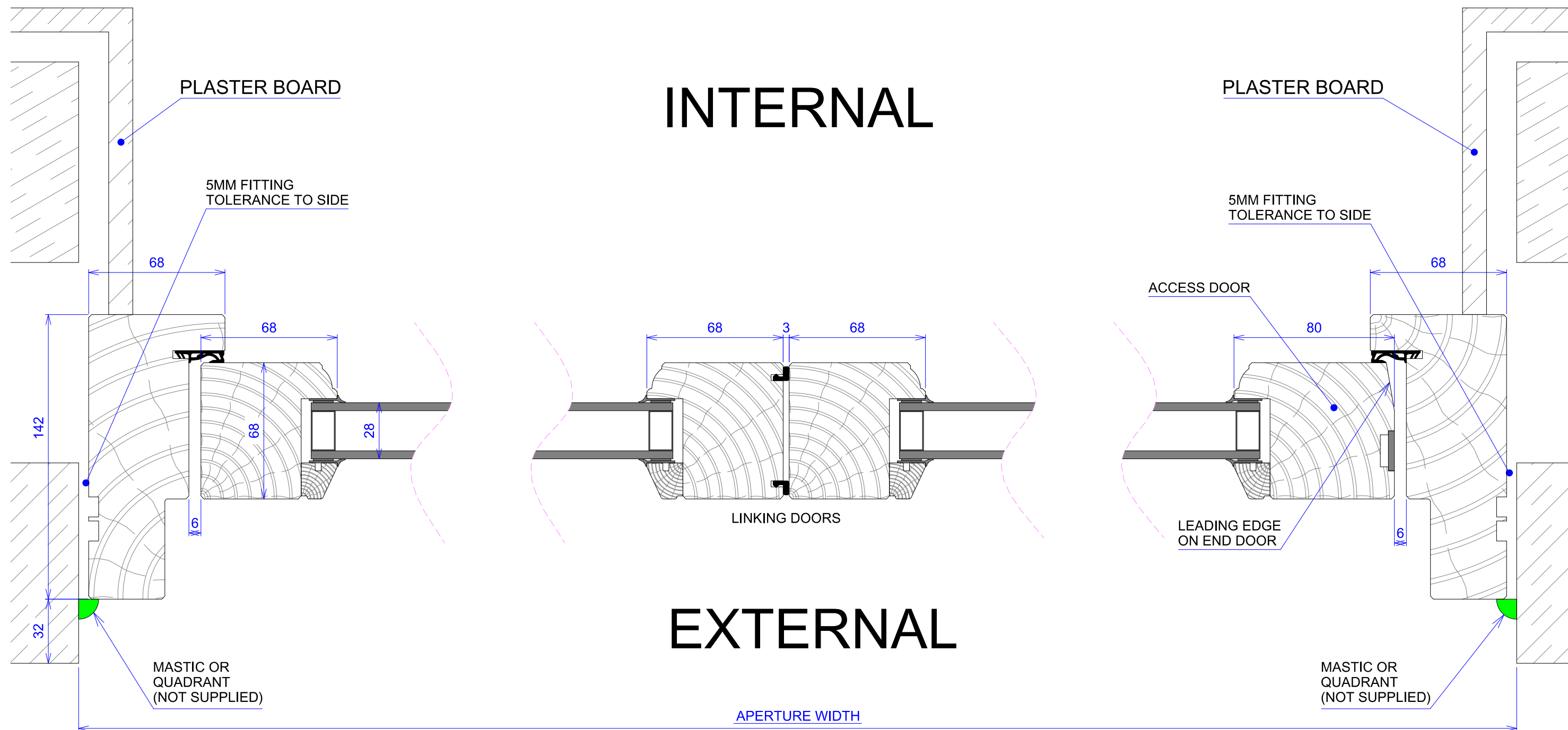

THE DOORS SHOWN ARE ODD AND ALL STACK TO THE LEFT (NO RIGHT DOORS).
IF THE DOORS ALL STACKED TO THE RIGHT THE ACCESS DOOR
AND THE LEADING EDGE WOULD BE THE OPPOSITE HAND TO THOSE ABOVE.

THE LEADING EDGE ON THE ACCESS DOOR IS NECESSARY TO ALLOW THE
DOOR TO SWING OPEN AND NOT COLLIDE WITH THE FRAME.

THE GAPS SHOWN ARE AS A GUIDANCE ONLY.
DUE TO THE NATURAL MOVEMENT OF TIMBER,
THEY MAY DIFFER SLIGHTLY FROM THOSE SHOWN.

ALL GAPS ARE ADJUSTABLE (APART FROM THE 3MM LINKING DOOR GAPS) AND SHOULD
BE ADJUSTED AS NECESSARY BY THE INSTALLER TO ENSURE CORRECT OPERATION.

	BIFOLD DOORS	AUTHOR Luke Wynder		
		DATE 03/05/2012		
	HORIZONTAL CROSS SECTION - OPEN OUT			
A3	ALL LEFT (ODD)			01

